



iC-150II

Multifunctional
instrument amplifier

Product manual



Product manuals

Thank you for choosing a DK product. Please take some time to read this manual to understand all the features of your system and take advantage of all its performance capabilities. All DK products are CE approved and designed for continuous use in professional applications.

iC-150 is an all-in-one battery-powered personal PA system featuring multiple inputs and BLUETOOTH connectivity. Hosted in a compact, lightweight yet ultra-durable polypropylene cabinet with multiple aiming positions, it represents the perfect solution for musicians, DJ and general PA users.

An array of three high-definition 2.75" HF speakers coupled with a powerful 6.5" LF woofer provides a consistent tonal balance, a strong output level over distance and a wide coverage of large audiences. The state-of-the-art electronics includes a sophisticated pre-amp section with DSP processor and a powerful 150W + 50W Class D power amplifier. The built-in 2 mono + 1 stereo channel digital mixer allows to connect two microphones or instruments and a stereo player, each one with independent level controls. A 2-band EQ and a studio-grade digital REVERB is also available for microphone/instrument inputs. The built-in BLUETOOTH connection allows to stream high quality audio from portable devices without the need of any cable. The built-in Li-ion battery provides up to 10 hours of mains-free continuous operation, for the maximum freedom of use.

iC-150 is a Multi-functional musical instrument speaker,which can bring us happiness and inspire artistic creation anytime and anywhere.

Weight light,with z designed handle,easy to carry out to everywhere .And there is a battery built-in,can has a long playtime.

Parameters :

System type: 2-way vented enclosure with HF array
High Frequency Device: 3 x 2.75" HF speakers
Low Frequency Device: 1 x 6.5" woofer
Frequency response (-3 dB): 60 Hz - 18 kHz
Max. SPL: 115 dB
Coverage angle (H x V): 120° x 50°
HF continuous power: 50 W class D
LF continuous power: 150 W class D
Input Connectors: 2 x XLR/TRS Combo (balanced); 1 x 3.5mm Jack Stereo
Output Connectors: 1 x 6.35mm Jack (unbalanced); 1 x USB type A Charge port
Input Channels: 2x MIC/LINE; 1x LINE/BT
Mic/Line Controls: Reverb, Low, High, Level
Processing: 32bit DSP, 24bit AD/DA
Bluetooth: 5.3, Audio Streaming
Enclosure material: Polypropylene
Finish: Black Textured
Grille material: Powder coated steel
Handles: 1 x top
Mounting Pole: 1x bottom
Dimensions (H x W x D): 320 mm x 240 mm x 290 mm
Weight: 7.5 kg
USB charging : 1 A
Power Supply : 100 - 240 V~, 50 / 60 Hz
Consumption : 150 W
Battery type: Rechargeable Lithium-ion 6000mAh
Battery play time (at medium level): up to 10 hours
Recharging time: less than 4 hours

Control panel

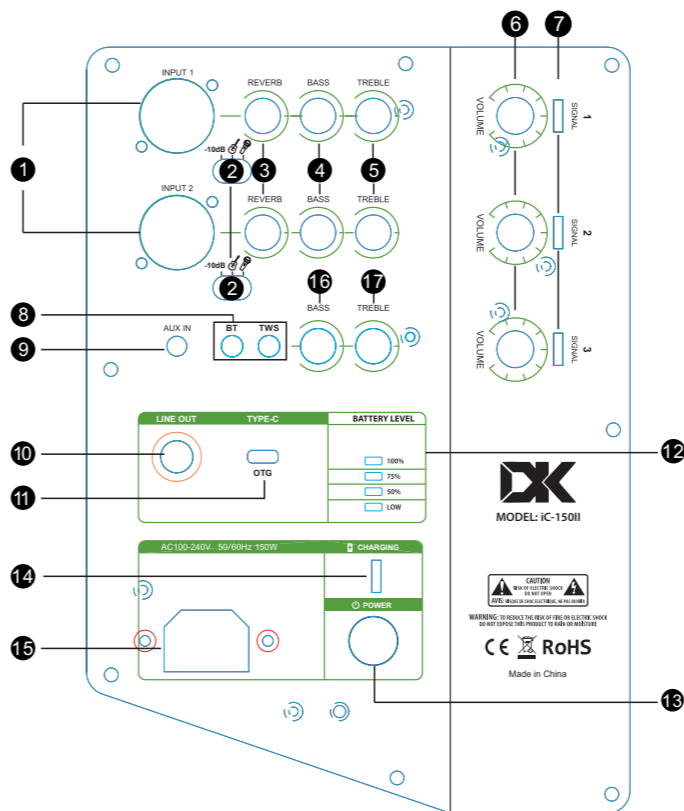

MAIN PANEL OPERATIONS

1. CH1 /CH2 INPUT

These are a COMBO connectors that accept XLR plugs or JACK plugs. The balanced XLR input is wired as follows:

Pin 1 = shield or ground
Pin 2 = + positive or "hot"
Pin 3 = - negative or "cold"

It accepts any MIC level signal from a dynamic microphone connected using an XLR cable. The unbalanced JACK input is wired as follows:

Tip = + positive or "hot"

Sleeve = shield or ground

This is a high impedance input that accepts a JACK plug from any instrument or line level instrument like acoustic guitar, fiddle pickup, electric guitar and so on.

2. CH1 / CH2 LINE/GUITAR/MIC

These switches set the optimal sensitivity and impedance of channel inputs between LINE, GUITAR or MICROPHONE.It is used for 6.35 capacitor self-powered microphones with high gain

3. CH1 / CH2 REVERB

These potentiometers set the level of CH1 / CH2 channels reverb effect.

4. CH1 / CH2 LOW

These potentiometers set the CH1 / CH2 channels low EQ.

5. CH1 / CH2 HIGH

These potentiometers set the CH1 / CH2 channels high EQ.

6. CH1 / CH2 / CH3 LEVEL

These potentiometers set the level of CH1 / CH2 / CH3 channels.

7. CH1 / CH2 / CH3 SIGNAL

These GREEN LEDs illuminates when a signal is present at the inputs.

8. Bluetooth button and Bluetooth pairing button

Boot default Bluetooth mode, long press to disconnect connected Bluetooth devices.

It is also the channel input3, AUX-3.5 has the priority function, if you insert the AUX cable, automatically switch to the AUX mode, remove the AUX cable, and automatically enter the Bluetooth mode.

AUX (LINE IN) is music input, that is, insert LINE IN automatically to LINE IN mode/regardless of whether there is a signal, Bluetooth sound is suspended, not out of Bluetooth mode, if you press the Bluetooth playback key on the phone, Bluetooth playback but no sound output, only unplug AUX input plug, Bluetooth has sound.

TWS is Bluetooth pairing, that is, two machines work in stereo at the same time, Press and hold the TWS button to turn the pairing function on and off.

9. Aux IN (MINI JACK)

This is a MINI JACK (3.5mm) female connector that accepts a STEREO MINI JACK plug from Computer / CD / DVD / MP3 players. The MINI JACK is wired as follows:

Tip = positive signal of left channel Ring = positive signal of right channel Sleeve = shield or ground

10. LINE OUT (JACK)

This female JACK connector provides an unbalanced line-level signal with the mix of all the inputs.

Connect it to the input of another audio system or powered speaker.

11. USB port is a TYPE C interface, OTG interface communication

A. Debugging, after connecting the computer, you can use professional software to tune the speaker

B. Upgrade. After connecting the computer, you can upgrade the speaker with professional software

C. Sound card, can be connected to the computer to play music in the computer. You can also connect the mobile phone, play the music on the mobile phone, can be used as a mobile phone and computer recording!

D. Can not be charged, if some mobile phones can not communicate, you need to open the OTG control on the mobile phone

12. BATTERY LEVEL

This LED bar shows the battery level when the sound system is switched on, Judge the power according to the light display.

LOW: this RED LED indicates that the residual power of the internal battery is lower than 50% of the capacity (the other LEDs are off). When this LED is on, connect your system to a mains line.

13. POWER switch

Press the power button to turn on, and the power button will turn on the green light.

Note: if the unit is connected to the mains line, the internal supply circuit charges the battery also if the unit is switched off. In order to extend the battery life, the charging starts when the battery level is below 75% of the capacity, whether the system is on or off.

14. CHARGE LED

GREEN: indicates the equipment is connected to the AC power and the battery is fully charged.

RED: indicates the equipment is connected to the AC power and the battery is charging.

Note: When playing music with high power under AC power supply after the battery is fully charged, the charging indicator light may keep switching between red and green due to high power consumption. This is because the power consumption is high and the switching power supply output energy is insufficient, so it will consume battery power. This is a normal phenomenon, please use with confidence.

15. AC~ SOCKET

Here's where you plug in your mains supply cord. You should always use the mains cord supplied with the device.

16. Channel input3: Input AUX or Bluetooth mode bass adjustment, clockwise rotation increases, counterclockwise rotation decreases.

17. Channel input3: Input AUX or Bluetooth mode treble adjustment, clockwise rotation increases, counterclockwise rotation decreases.